

P5063 Firerock

Preschool Series Super 6 Volt

Age Range: 2 to 6 years
 Weight Limit: 65 lbs
 Surfaces: Hard and grass
 Speed: 3.5 mph Forward
 3.5 mph Reverse
 Colors: blue and red
 Intro: 2009
 Suggested Retail:
 Box Dimensions: 20 x 26 x 36
 54 lbs
 Warranty
 One Year Vehicle
 6 Months Battery

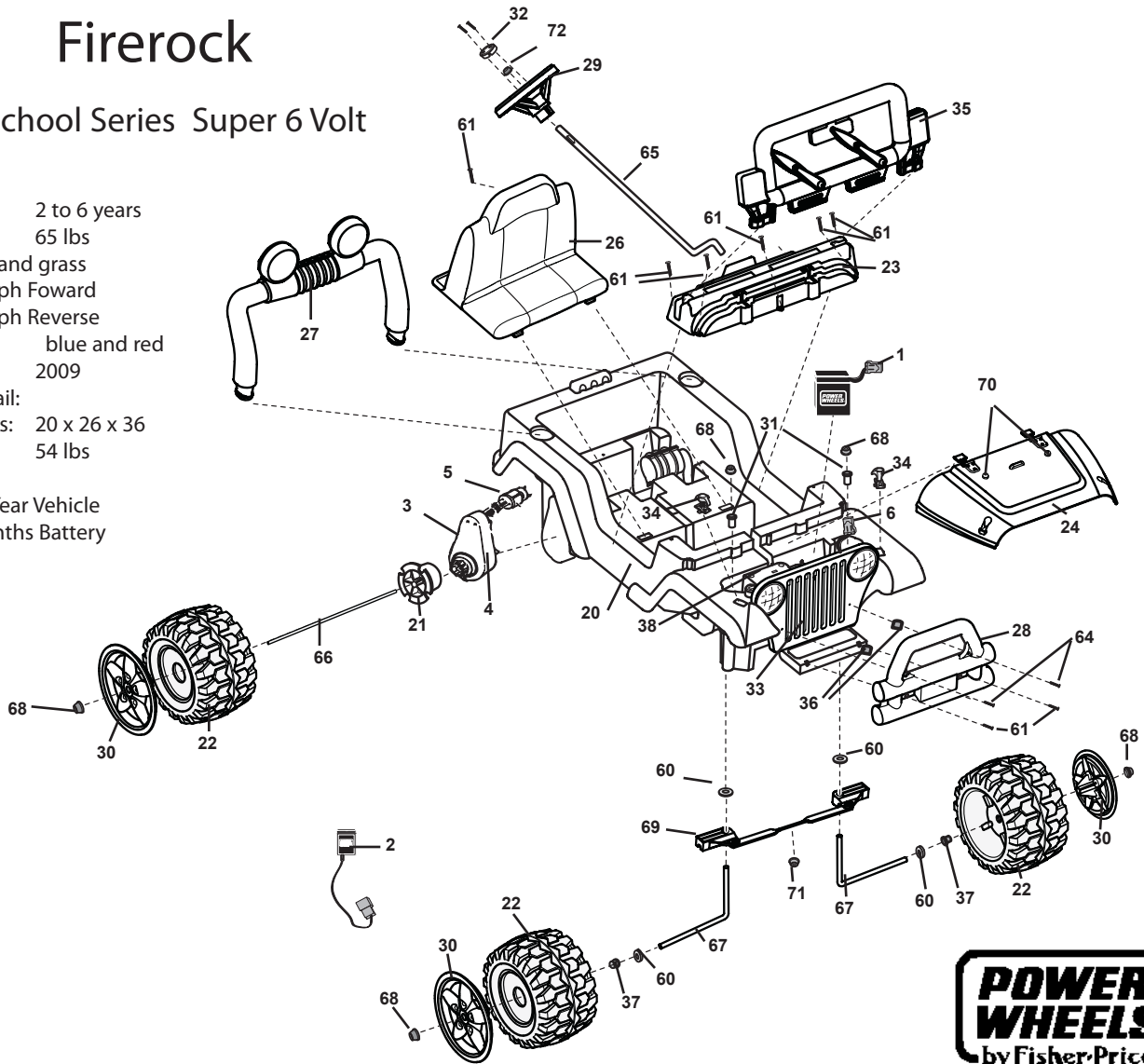

Item No.	Description	Part No.	Qty.	Item No.	Description	Part No.	Qty.	Item No.	Description	Part No.	Qty.
Working / Electrical Parts				Hardware / Metal Parts				Parts Not Shown			
1	Battery S6V w/fuse	00801-0712	1	36	Spacer Brushguard/Bumper	74460-2069	2		Parts Bag	P5063-93491	
2	Charger	00801-1481	1	37	7/16" Round Bushing (Black)	74550-2689	4		Hardware Bag	73610-9059	1
3	Motor Gearbox Assembly	74180-9519	2	38	Battery Retainer Assembly	75548-9409	1		Owner's Manual	P5063-0920	1
4	Gearbox W/out Motor	74550-9279	2						Main Decal	P5063-0310	1
5	Motor Pinion Assembly	74580-9539	2						Headlight Label	P5063-0330	1
6	Main Harness Assembly	73610-9569	1						Foot switchPlunger type	00801-1566	1
Plastic / Other Parts				60	Washer 7/16"	0801-0196	4		Cap Nut Tool	78640-2629	1
20	Body	N/A	1	61	Screw 10 x 1	N/A	9		Control Switch F/R	00801-1773	1
21	Wheel Driver	74460-2249	2	62	Metal Screw 8 x 1 N/A	0801-0224	2		PW Emblem	00801-1503	1
22	Wheel	B7659-2459	4	64	Screw Trusshead 8 x 4 N/A	0801-0301	2		Footboard Assembly	73610-9289D	1
23	Dash	3800-8835	1	65	Steering Column	K4564-4239	1		Hubcap Center	K4564-2679	1
24	Hood	P5063-9359	1	66	Rear Axle	H4435-4509	1				
			1	67	Front Axle	H4435-4519	2				
26	Seat	P5063-2319	1	68	Cap nuts .437	0801-0227	10				
27	Rollbar	P5063-2339	1	69	Steering Linkage	73610-9419	1				
28	Brushguard	P5063-2349	1	70	J-Lock Fastener	78570-2439	2				
29	Steering Wheel	P5063-2379	1	71	Steering Column Cap .354	00801-1620	1				
30	Hubcap	K4564-2469	4	72	5/32" x 1 1/2" Pin	00801-1565	1				
31	Long Bushing	73610-2689	2								
32	Steering Wheel Button	P5063-2729	1								
33	Grille	73610-2849	1								
34	Hoodlatch Silver	74020-9559	2								
35	Windshield	P5063-2619	1								

N/A = Not Available

Rev. 03/02/09

Bold and Underlined parts are to be purchased and installed by Service Centers only. These items may not be sold directly to consumers by Service Centers or Fisher-Price.